

## Motor Vibrator set for Vibro Flex Assembly instructions



The TREMIX VIBROFLEX is an efficient surface vibrator for vibration and levelling of concrete in bay widths up to 7 m. Since the screed is built as a modular system, the length of it can be adapted to different casting widths. The sections are available in 1 m and 2 m lengths. End sections are mounted at each end. They also act as supports for the lifting handles. The lower part of the end sections, the profile, is exchangeable and available in the following lengths: 0.2, 0.3 and 0.4 m.

In this way the total length can be made available in decimetre lengths.

The framework is of steel and the profiles of aluminium.

At each joint between two sections the angle can be adjusted to approximately 5°.

The vibration unit in the framework can be moved along the surface vibrator to fit the selected total length.

---

---

## Content of Motor vibrator set:

A	Motor vibrator	1 pcs
B	Motor bracket	2 pcs
C	Screw M12x35	4 pcs
D	Locking washer Nordlock M12	4 pairs
E	Carriage bolt M10x65	4 pcs
F	Screw M10x45	2 pcs
G	Capped locking nut M10	2 pcs
H	Washer 10,5x21x2 Fzb	4 pcs
I	Tie belt 0,5m	1 pcs

Furthermore 2 end pieces 33014 and modular sections up to wanted length are needed.

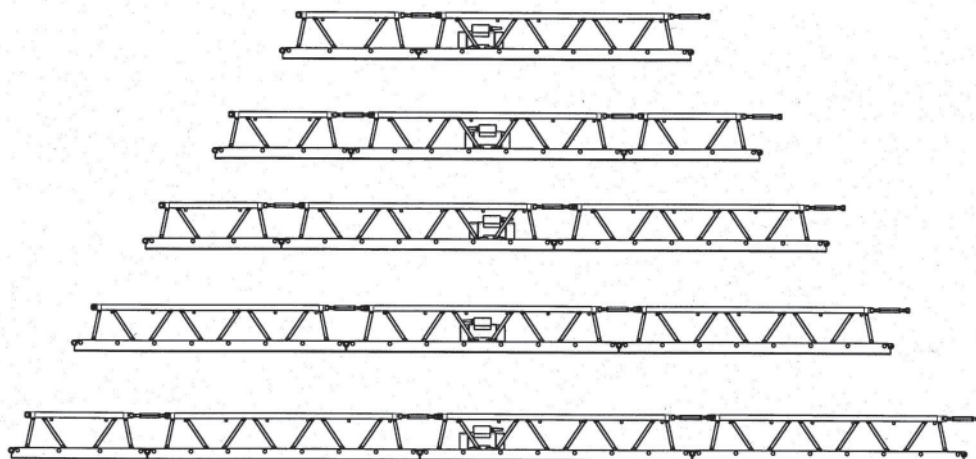

### Montage:

Place the sections after each other in the assembly order. Sections can be assembled in both directions. If a 1 m section is used it should be placed at the end.

Decide where to put the motor vibrator. It should be placed as close to the centre as possible. Check with the motor bracket.

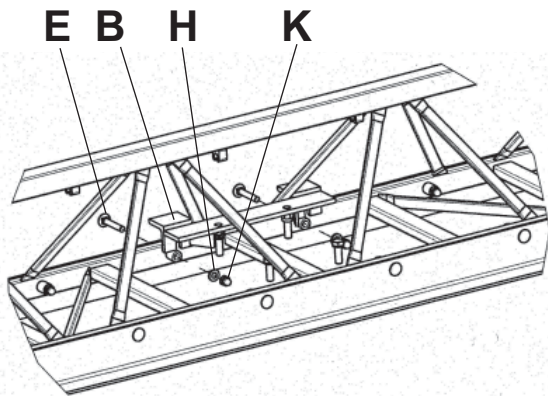

When the location of the motor vibrator has been decided, assemble the motor brackets (B) . Remove the 4 existing carriage bolts and replace them with the longer carriage bolts (E) supplied with this set. Use the washers (H) and the existing capped locking nuts (K).

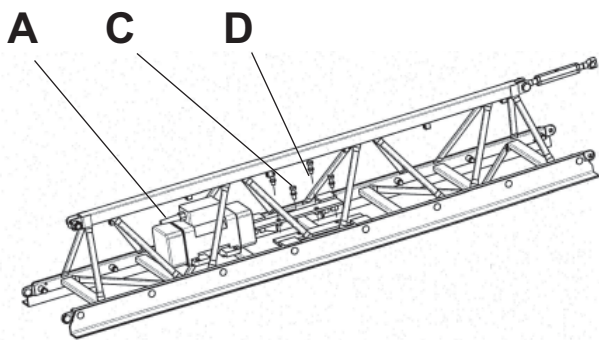

Slide the motor vibrator (A) in from the end and fasten it with the supplied screws (C) and the locking washers (D). If the surface vibrator is not crowned or knicked the electric equipment can be placed at either end. The Vibro Flex can be pulled in both directions and the motor vibrator can rotate forwards or backwards.

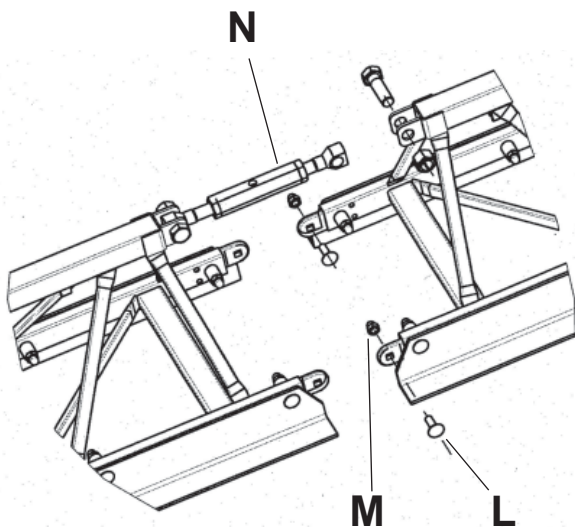

Assemble the sections with the carriage bolts (L) and the capped locking nuts (M) supplied with the sections. Straighten up roughly with the turn buckle screws, but do not tighten them.

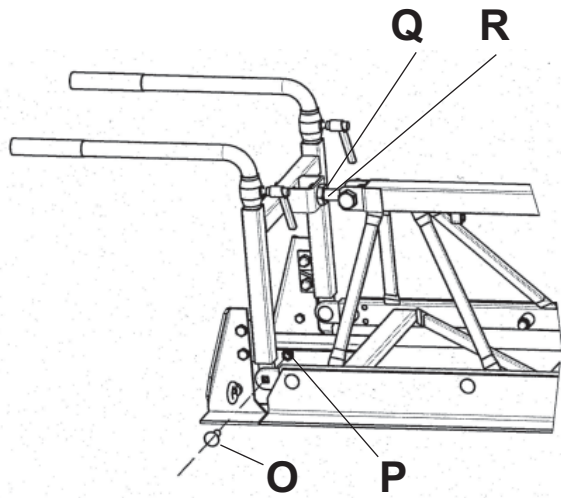

Assemble one endpiece (33014) at each end Use the supplied carriage bolts (O) and the capped locking nuts (P). Adjust the nuts (Q) on the link screw (R) in the upper part to make sure the end piece beam is in line with the section beam. Lock the handle bars in a convenient position.

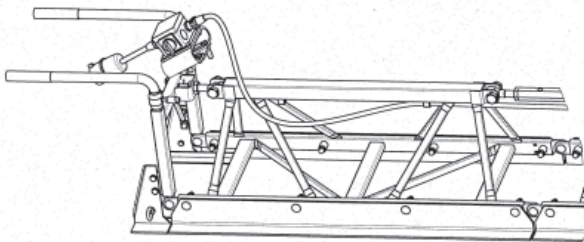

Assemble the electric box on one of the end pieces and push in the cable in the clamps under the top bar. If the total length is less than 7 m the excess cable shall be secured with the tie belt (I).

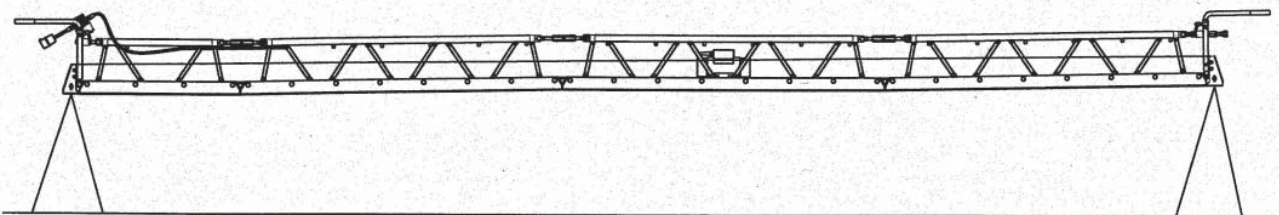

Put the screed on the screed rails or on 2 stands at the same distance as the screed rails. String a wire between the end pieces. Take care to put the wire at the same height over the screed in both ends. Measure the height up to the wire at each connection. Adjust with the turnbuckle screws until the screed is straight. N.B. If you have more than one connection you must go over all connection several times and check as the next connection influences the one before.

When the screed is straight shall the nut of the turnbuckle screws be tightened to avoid sagging.

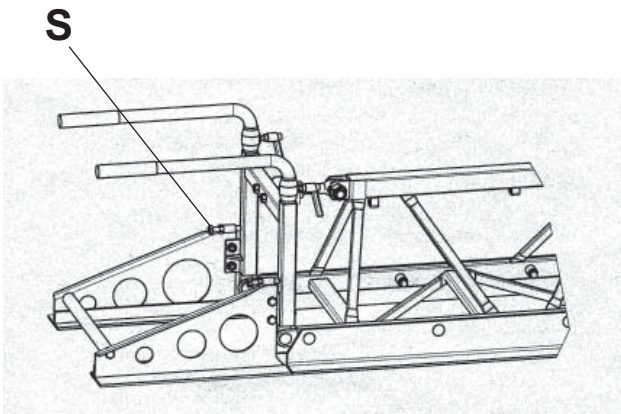

If you need special lengths extenders are available in lengths of 0.2m, 0.3m and 0.4m. Use the screws (S) to get the extenders in line with the sections.

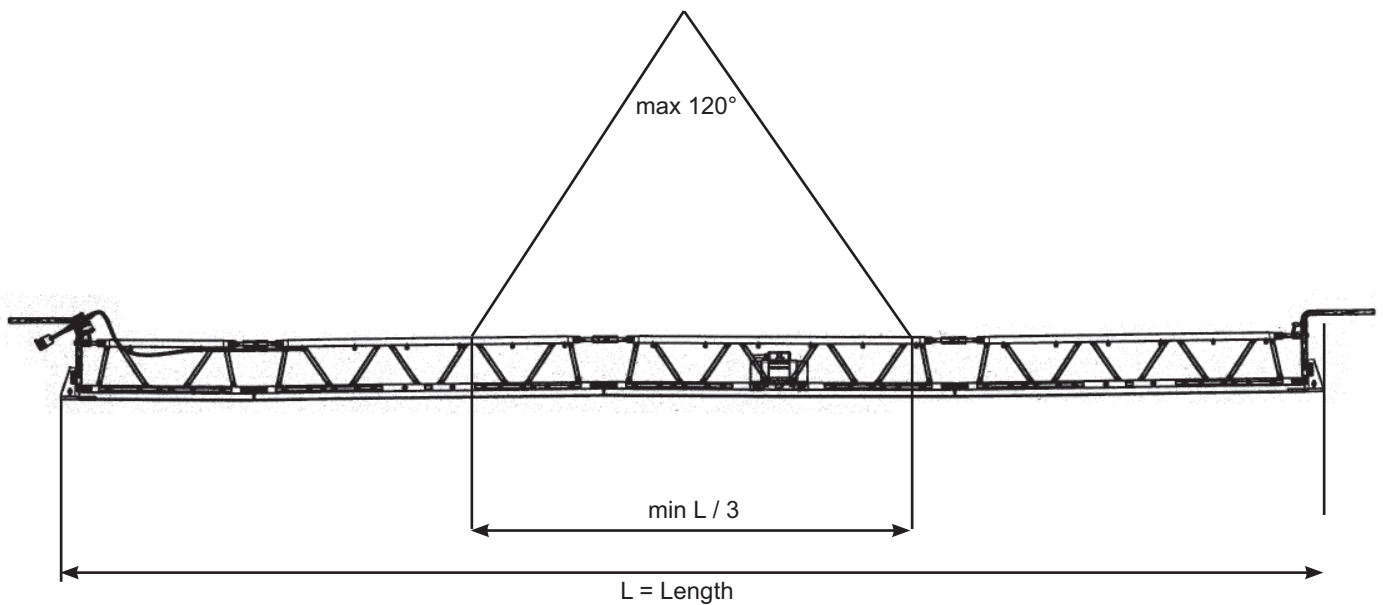

When lifting with crane use soft slings. Choose the connection points so that the sling can not slide.  
Remember to check the straightness after lifting.  
Do not step on the screed while using it. There is a risk for sagging.



*Nordic Construction Equipment AB, PO Box 226, SE-127 24 Skärholmen, Sweden.  
Tel. +46 8 603 32 00. Fax. +46 8 646 72 61. <http://www.tremix.com> 2005-02-11*